

AUBURN LAKES LIMITED PARTNERSHIP
DEED VOLUME 886, PAGE 865

NOTE:
L.C.A. DENOTES 'LIMITED COMMON AREA' FOR FIRST FLOOR ONLY.
ALL LAND NOT OCCUPIED BY BUILDINGS DESIGNATED AS
'LIMITED COMMON AREA' IS 'COMMON AREA'.

POINT BREEZE GO
(PRIVATE)

SAGEWOOD LANE 20
(PRIVATE)

SANDWOOD LANE 20
(PRIVATE)

I DO HEREBY CERTIFY THESE DRAWINGS SHOW GRAPHICALLY ALL PARTICULARS OF BUILDING 756 OF THE DECLARATION OF CONDOMINIUM FOR THE WOODS AT AUBURN LAKES, INCLUDING THE LAYOUT, LOCATION, DESIGNATION AND DIMENSIONS OF EACH FAMILY UNIT AND BUILDING AS CONSTRUCTED.



STEVEN J. LESSMAN, PROFESSIONAL SURVEYOR NO. 7078

EXHIBIT 'A'
DECLARATION OF CONDOMINIUM FOR THE WOODS AT AUBURN LAKES
BUILDING 756
MASTER SITE PLAN
SCALE: T = 30 JULY 1999 SHEET 2 OF 5
LESSMAN, BENDER & ASSOCIATES
Engineers - Surveyors - Planners
Village Station 401 South Street Chardon Ohio 44024
Phone: (440) 286-7204 Fax: (440) 286-3335

28-36

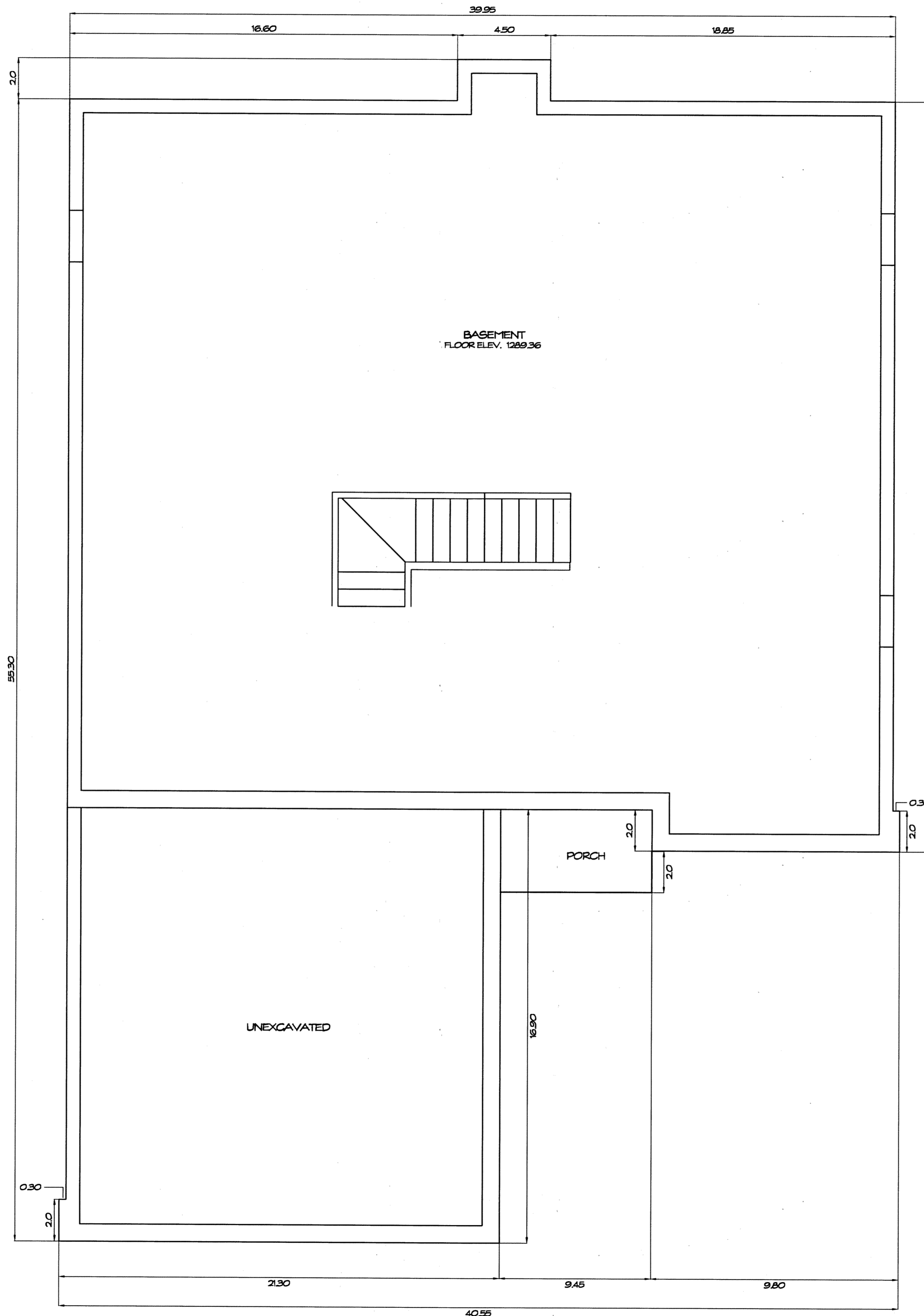

FOUNDATION PLAN
1/4" = 1'-0"

WE DO HEREBY CERTIFY THESE DRAWINGS SHOW GRAPHICALLY ALL PARTICULARS OF BUILDING 756 OF THE DECLARATION OF CONDOMINIUM FOR THE WOODS AT AUBURN LAKES, INCLUDING THE LAYOUT, LOCATION, DESIGNATION AND DIMENSIONS OF EACH FAMILY UNIT AND BUILDING AS CONSTRUCTED.



STEVEN J. LESSMAN, PROFESSIONAL SURVEYOR NO. 7078

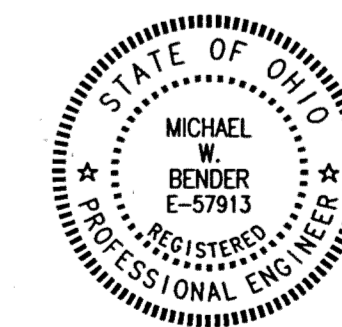

Michael W. Bender
MICHAEL W. BENDER, PROFESSIONAL ENGINEER NO. E-57913

EXHIBIT "A"
DECLARATION OF CONDOMINIUM FOR THE WOODS AT AUBURN LAKES
BUILDING 756
SCALE: 1/4" = 1'-0" | JULY, 1999 | SHEET 3 OF 5
LESSMAN, BENDER & ASSOCIATES
Engineers - Surveyors - Planners
Village Station 401 South Street Chardon Ohio 44024
Phone: (440) 286-7204 Fax: (440) 286-3333

28-37

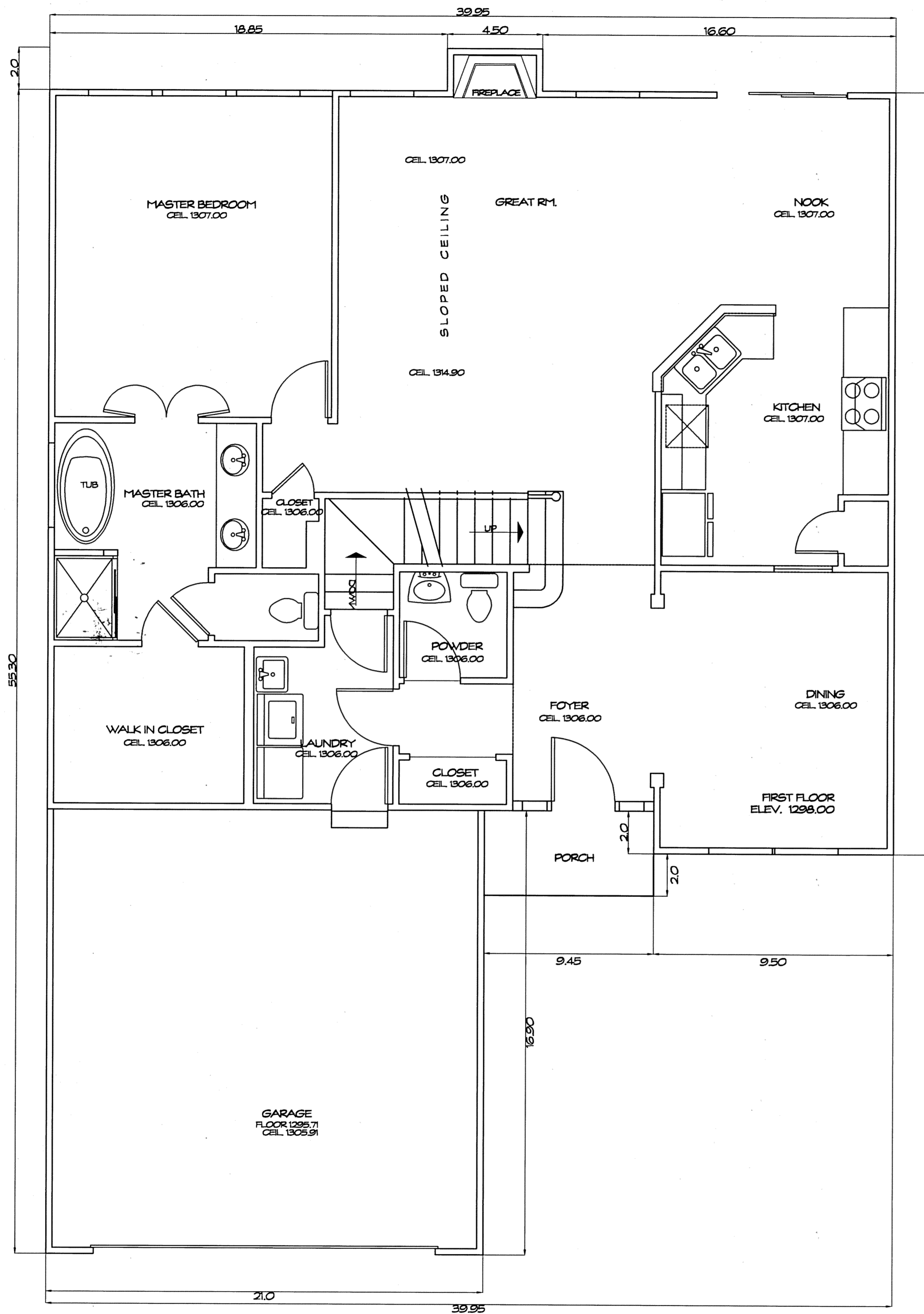

FIRST FLOOR PLAN
1/4" = 1'-0"

UNIT	GARAGE ELEV.		SQ. FT.	BASEMENT ELEV.		SQ. FT.	1ST FLOOR ELEV.		SQ. FT.	2ND FLOOR ELEV.		TOTAL SQ. FT.
	FLOOR	CEILING		FLOOR	CEILING		FLOOR	CEILING		FLOOR	CEILING	
756	1295.71	1305.91	360	1289.36	1297.21	1429	1298.00	SEE PLAN	1387	1306.90	1314.90	3745

WE DO HEREBY CERTIFY THESE DRAWINGS SHOW GRAPHICALLY ALL PARTICULARS OF BUILDING 756 OF THE DECLARATION OF CONDOMINIUM FOR THE WOODS AT AUBURN LAKES, INCLUDING THE LAYOUT, LOCATION, DESIGNATION AND DIMENSIONS OF EACH FAMILY UNIT AND BUILDING AS CONSTRUCTED.



Steven J. Lessman
STEVEN J. LESSMAN, PROFESSIONAL SURVEYOR NO. 7078

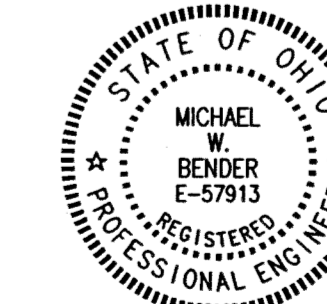

Michael W. Bender
MICHAEL W. BENDER, PROFESSIONAL ENGINEER NO. E-57913

EXHIBIT "A"
DECLARATION OF CONDOMINIUM FOR THE WOODS AT AUBURN LAKES
BUILDING 756
SCALE: 1/4" = 1'-0" JULY, 1999 SHEET 4 OF 5
LESSMAN, BENDER & ASSOCIATES
Engineers - Surveyors - Planners
Village Station 401 South Street Canton Ohio 44704
Phone: (440) 286-7204 Fax: (440) 286-3333

28-38

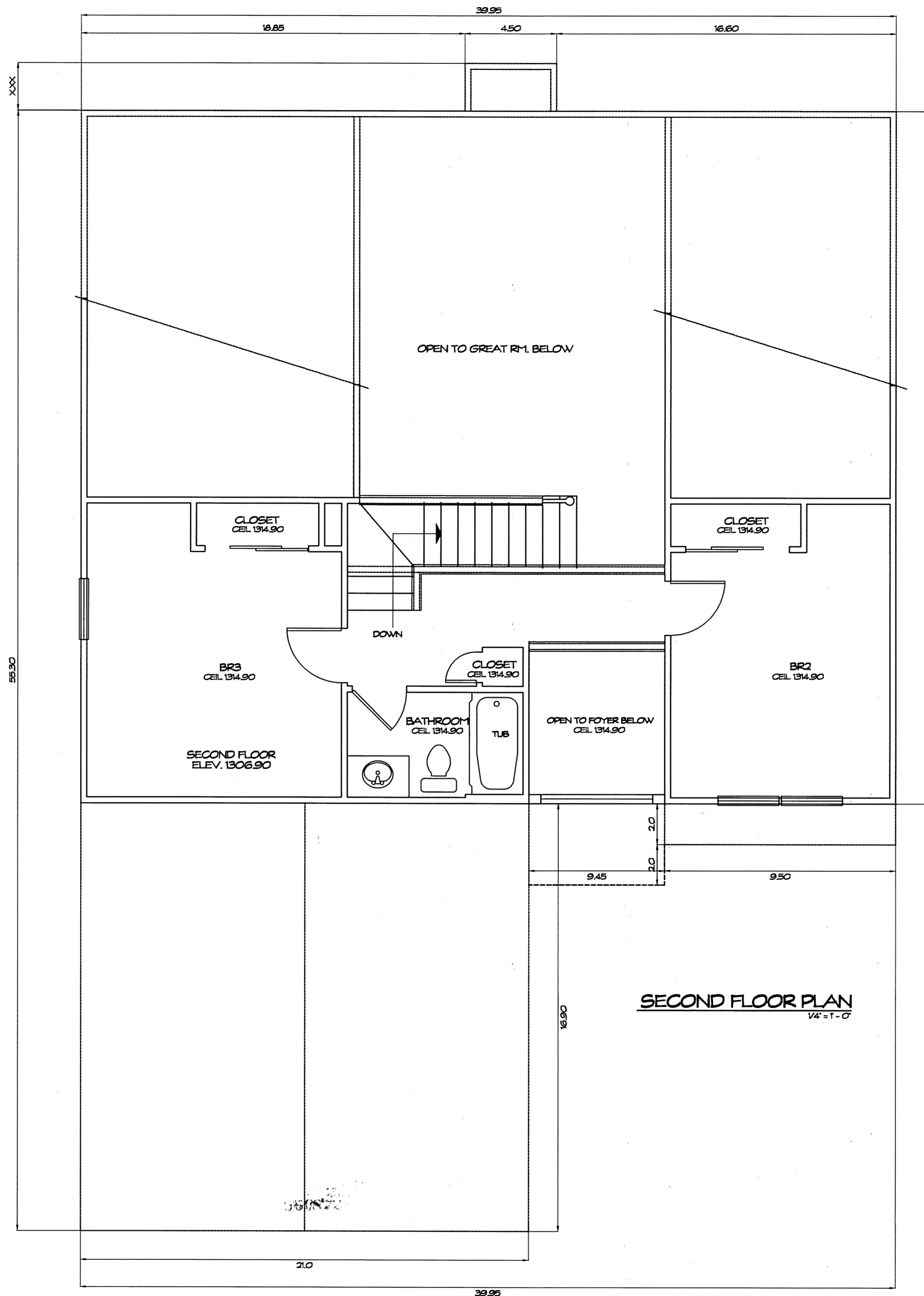

WE DO HEREBY CERTIFY THESE DRAWINGS SHOW GRAPHICALLY ALL PARTICULARS OF BUILDING 756 OF THE DECLARATION OF CONDOMINIUM FOR THE WOODS AT AUBURN LAKES, INCLUDING THE LAYOUT, LOCATION, DESIGNATION AND DIMENSIONS OF EACH FAMILY UNIT AND BUILDING AS CONSTRUCTED.



Steven J. Lessman
STEVEN J. LESSMAN, REGISTERED PROFESSIONAL SURVEYOR NO. 7076

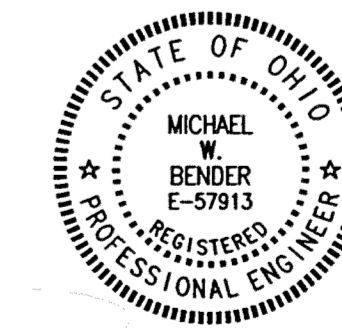

Michael W. Bender
MICHAEL W. BENDER, REGISTERED PROFESSIONAL ENGINEER NO. 5-57913

EXHIBIT "A"
DECLARATION OF CONDOMINIUM FOR THE WOODS AT AUBURN LAKES
BUILDING 756
SCALE: 1/4" = 1'-0" | JULY, 1999 | SHEET 5 OF 5
LESSMAN, BENDER & ASSOCIATES
Engineers - Surveyors - Planners
Village Station 401 South Street Chardon Ohio 44024
Phone: (440) 286-7204 Fax: (440) 286-3335

28-39